

Notes of George Wear's survey
Beginning at a W.O. thence in
the Wm. Findley tract.

- South 40 per B.O.
- S 28 E 12 " Stones
- N 3 E 40 "
- N 45 E 8 "
- N 62 E 22 " Bunch of Walnuts
- N 65 W 27 "
- S 28 W 19 " W.O.

to the place of Beginning
Extract from the draught on file

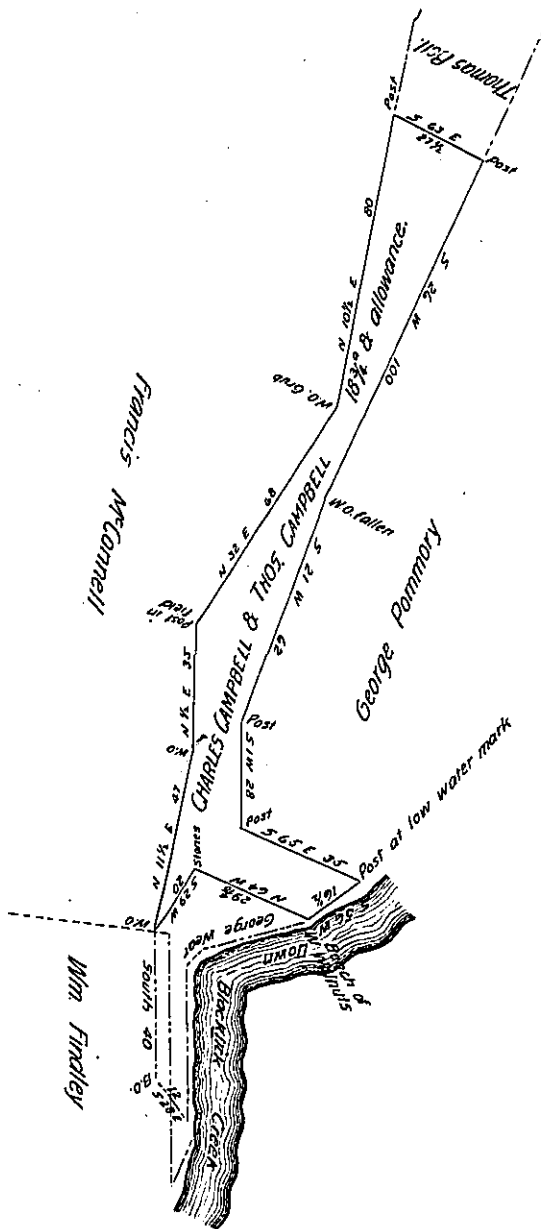

Surveyed 2nd February 1842 to Charles & Thomas Campbell the above described piece of land containing Eighteen acres and three quarters and allowance of six per cent with an improvement of about two or two and one half acres cleared and fenced situate adjoining lands originally surveyed to William Findley, George Wear, Francis McConnell Thomas Bell and Blacklick creek as above described in Blacklick Township Indiana County By Virtue of a Warrant granted to Charles Campbell ~~senior~~ dated 23rd day of Dec^r 1824.
To Jacob Sallade Esq^r Surveyor General.

Robert M^cGee D. S.

N. B. There is filed in this office a draught of survey of 25th Oct^r 1826 (including all of the above described piece of land) By Virtue of the above recited warrant with a note endorsed on said draught "the return of this survey was sent back from the Surveyor Generals Office with these words endorsed" "Part of the within previously surveyed on older warrant therefor cannot be accepted unless satisfactory reason given" It appears according to papers on file that George Wear obtained a warrant for three acres of land dated 9th December 1822 and survey made 24th of April 1823, and Charles Campbell ~~senior~~ set up a claim and in making his survey 25th Oct^r 1826 took in all of Wear's survey outside the William Findley line and extended 29 perches below Wear's survey But now his sons Charles and Thomas in making the above survey go no further than to Wear's survey leaving it out and all below it that was included in the first survey.

R. M^c - D. S.

J. S. S. G.

P. S. According to draught on file the first or 25th Oct^r 1826 survey when Wear's was taken in 17^o & allowance But now leaving Wear's out 18^o & allowance the readiest apology that I can make is that the land in these parts appears to be growing.
Jac. Sallade Esq^r S. G.

Robt M^cGee D. S.

IN TESTIMONY that the above is a copy of the original remaining on file in the Department of Internal Affairs of Pennsylvania, made conformably to an Act of Assembly approved the 16th day of February, 1833, I have hereunto set my Hand and caused the Seal of said Department to be affixed at Harrisburg, this

fourth day of August 1905

Joac B. Brown
Secretary of Internal Affairs.